

# **Boxer Extract AHU - Size 3-7** **Revit Model Features**

1. The model uses a type catalogue so all variants of the Boxer extract AHU between size 3-7 can be inserted using the same .rfa file (see Read Me file attached for further info)

The ESBHEX.rfa model attached includes the following options in the Model Properties Category in the Properties Window

Model Properties	
Roof	<input type="checkbox"/>
Show Intake Side Silencer	<input type="checkbox"/>
Show Discharge Side Silencer	<input type="checkbox"/>
Show Access Clearance	<input checked="" type="checkbox"/>

2. 'Roof' allows you to show or hide the weatherproof cover and control box surround if required (or if offered as part of the selection).

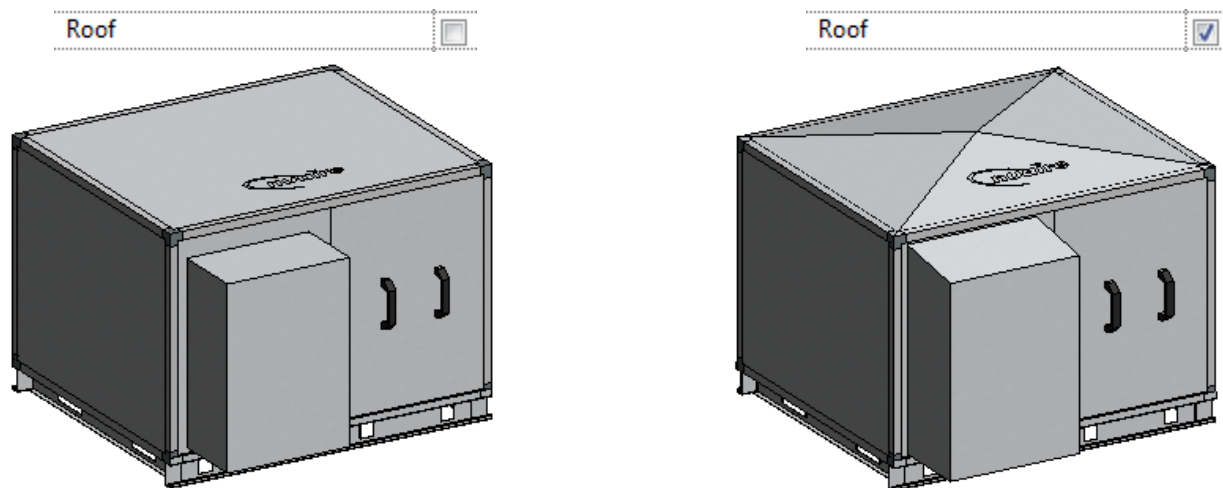

3. 'Show Intake Side Silencer' and 'Show Discharge Side Silencer' allow you to show or hide the 900mm matched attenuator we offer (ESBSIL\*) for the appropriate side of the AHU.

Show Intake Side Silencer	<input type="checkbox"/>
Show Discharge Side Silencer	<input type="checkbox"/>

Show Intake Side Silencer	<input checked="" type="checkbox"/>
Show Discharge Side Silencer	<input type="checkbox"/>

Show Intake Side Silencer	<input checked="" type="checkbox"/>
Show Discharge Side Silencer	<input checked="" type="checkbox"/>

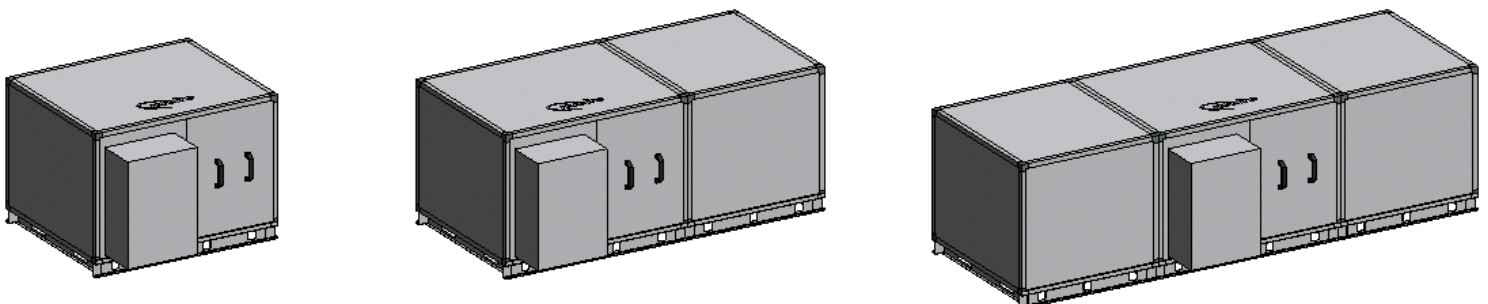

Continued...

4. 'Show Access Clearance' allows you to show or hide the access clearance transparent area of the model.

**Note:** If the access clearance area is hidden it will still affect the collision detection analysis.

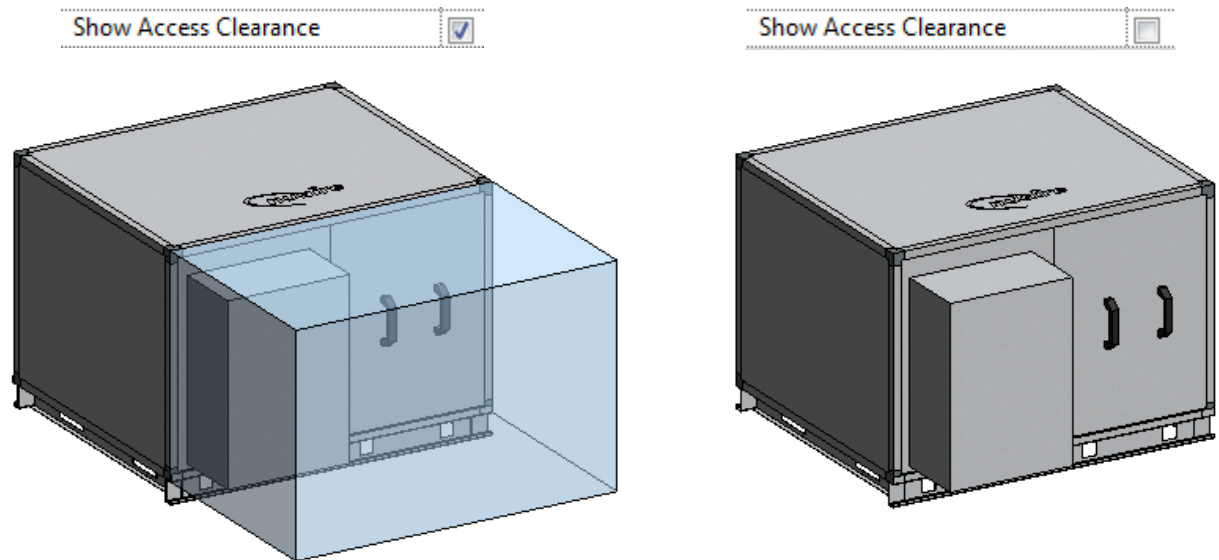

5. If the model is inserted into the project without using the correct procedure then you will be alerted via a red box and '**DO NOT USE**' wording around the model. The model code will also show this same message in the schedules. Please then refer to the additional 'Please Read Me' file packaged with this family for the correct insertion procedure.

