

# **ESX1-19-B Revit Model**

## **Features**

1. The model uses a type catalogue so all sizes of the Quietscroll ESX-B range between sizes 1 and 19 can be inserted using the same .rfa file (see Read Me file attached for further info)

The esx1-19-b.rfa model attached includes the following options in the Model Properties category in the Properties window

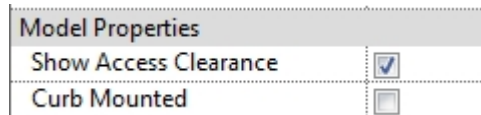

2. 'Show Access Clearance' allows you to show or hide the access clearance transparent area of the model.

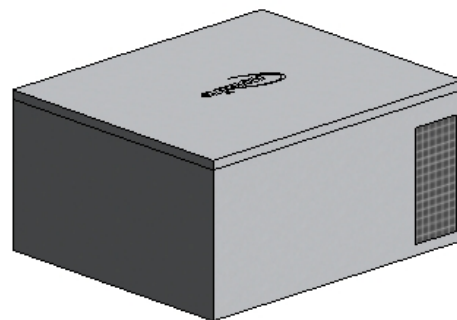
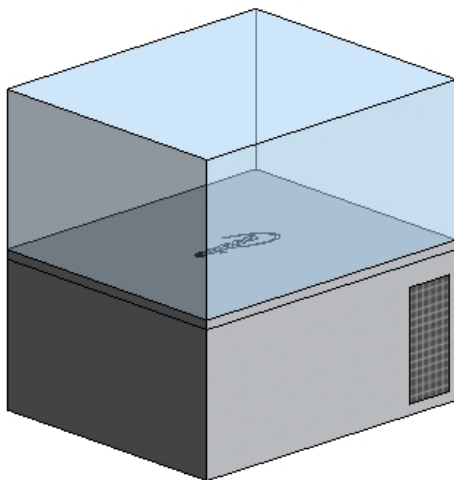
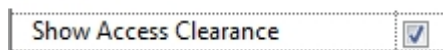

3. 'Curb Mounted' takes into account the lip under the unit for curb mounting and therefore the model will sit that little bit lower instead of floating above the curb.

