

nuaire DAVE Supply **Revit Model Features**

1. The model uses a type catalogue so all sizes of the Dave supply fan range can be inserted using the same .rfa file (see Read Me file attached for further info)

The DS-ES.rfa model attached includes the following options in the Model Properties Category in the Properties Window

Model Properties	
Show Weather Cover	<input checked="" type="checkbox"/>
Flip Weather Cover	<input type="checkbox"/>
Show Access Clearance	<input checked="" type="checkbox"/>
Show Access Clearance on Top	<input type="checkbox"/>
Show Access Clearance on Bottom	<input checked="" type="checkbox"/>

2. 'Show Access Clearance' allows you to show or hide the access clearance transparent area of the model. There are also options to choose between the optional top and/or bottom access the unit offers.

Show Access Clearance	<input checked="" type="checkbox"/>
Show Access Clearance on Top	<input type="checkbox"/>
Show Access Clearance on Bottom	<input checked="" type="checkbox"/>

Show Access Clearance	<input checked="" type="checkbox"/>
Show Access Clearance on Top	<input checked="" type="checkbox"/>
Show Access Clearance on Bottom	<input checked="" type="checkbox"/>

Show Access Clearance	<input type="checkbox"/>
Show Access Clearance on Top	<input type="checkbox"/>
Show Access Clearance on Bottom	<input type="checkbox"/>

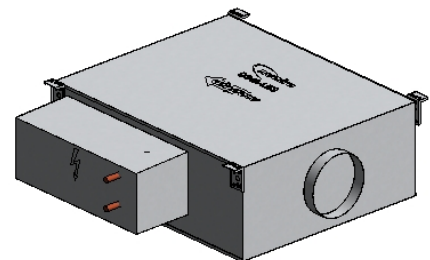
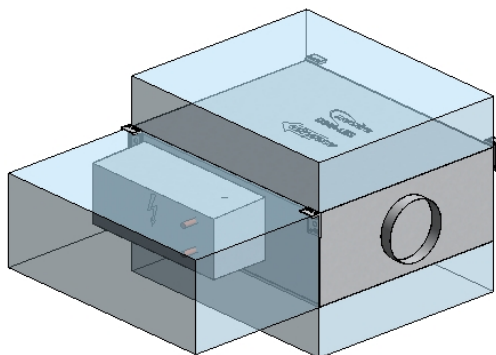
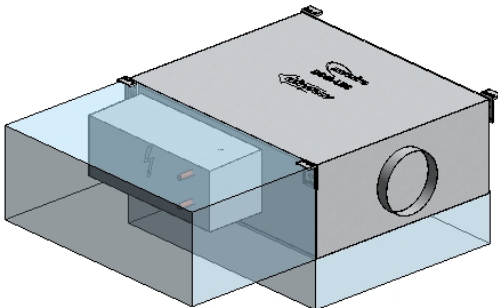

3. 'Show Weather Cover' allows you to show or hide the weather cover over the control box. This cover ships with the unit as standard but is not required if the unit is located internally so can be hidden as required.

Show Weather Cover	<input checked="" type="checkbox"/>
--------------------	-------------------------------------

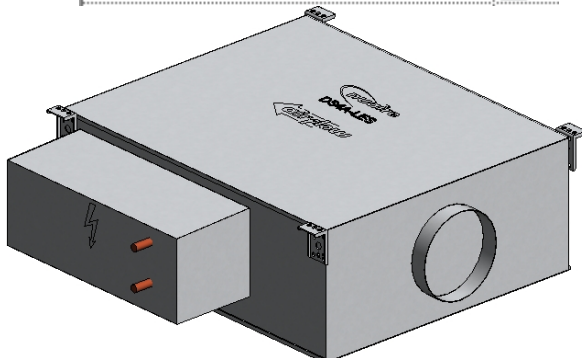

Show Weather Cover	<input type="checkbox"/>
--------------------	--------------------------

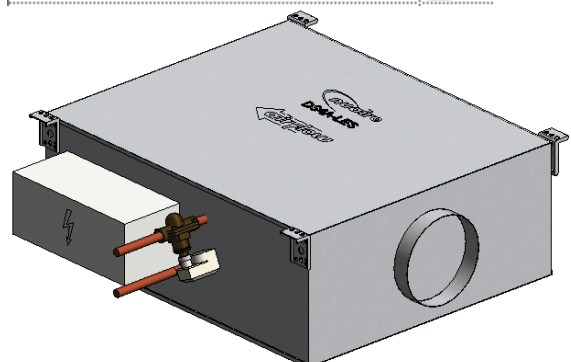

Continued on next page...

4. If the unit is mounted upside-down and externally then the weather cover will need to be removed and attached back on the other way up to maintain the controls' protection. 'Flip Weather Cover' lets you do this on the Revit file.

